



SUBARU

PART NUMBER: J101SFL600
NUMÉRO DE PIÈCE :

DESCRIPTION: Crosstrek Splash Guard Kit
DESCRIPTION : Nécessaire de pare-boue pour le Crosstrek

INSTALLATION INSTRUCTIONS INSTRUCTIONS D'INSTALLATION

KIT CONTENTS:
CONTENU DE L'ENSEMBLE

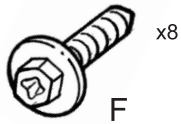
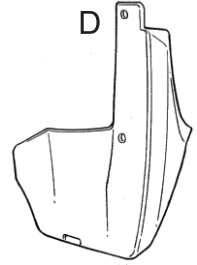
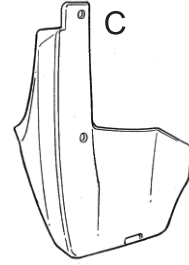
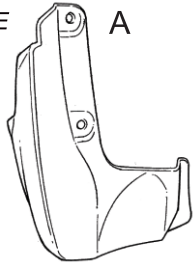

TOOLS REQUIRED
OUTILS REQUIS

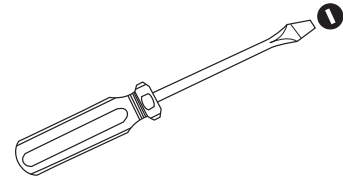
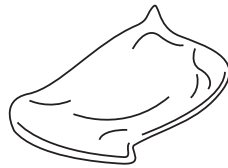
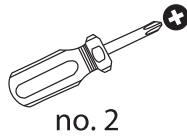

MEANING OF CHARACTERS:
SIGNIFICATION DES SYMBOLES :



Remove
Enlever



Install
Installer



Re use
Réutiliser



Discard
Jeter/recycler

1 Front Installation
Installation à l'avant

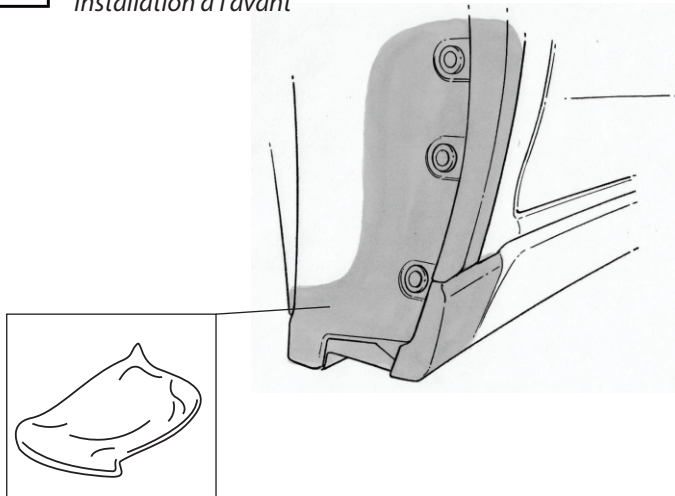

2

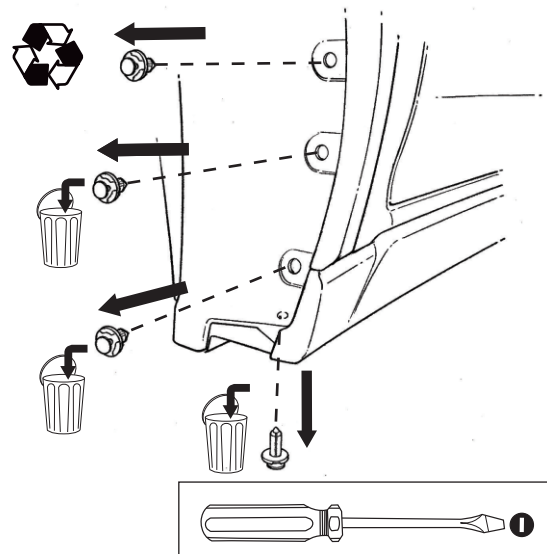

ISSUE
ÉDITION
01

DATE
March 21st, 2017
DATE
Le 21 mars 2017

SUBARU OF AMERICA

PAGE
1/3

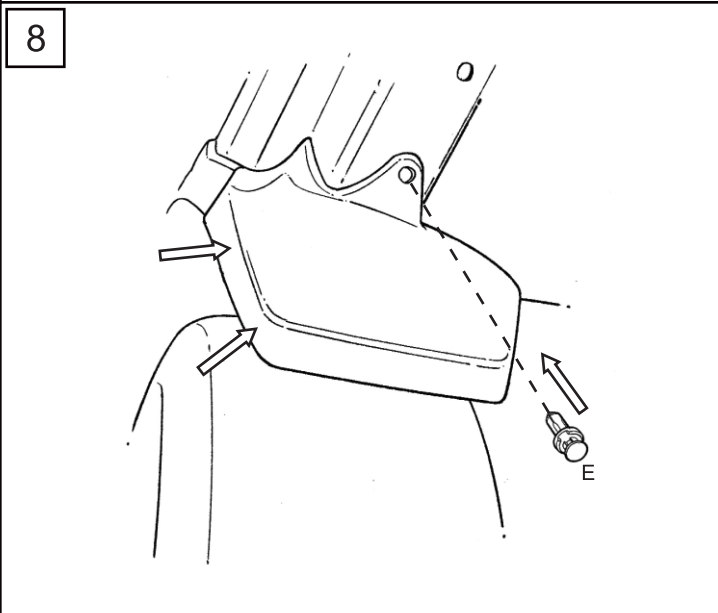
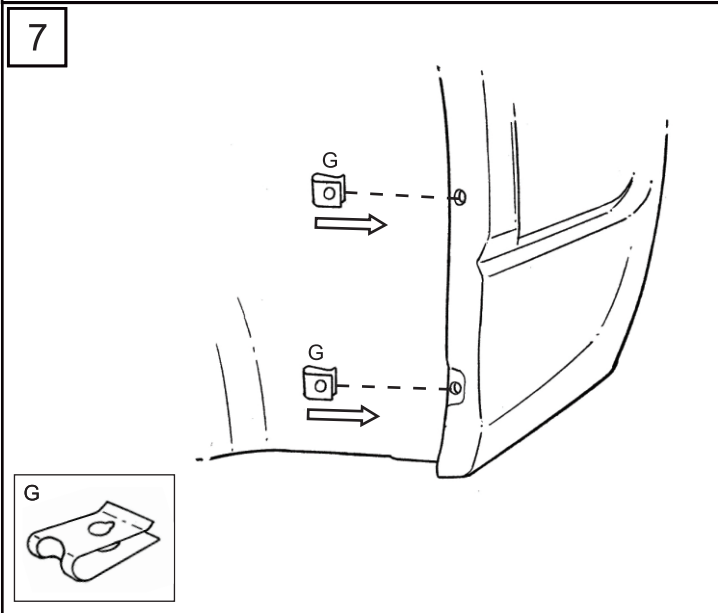
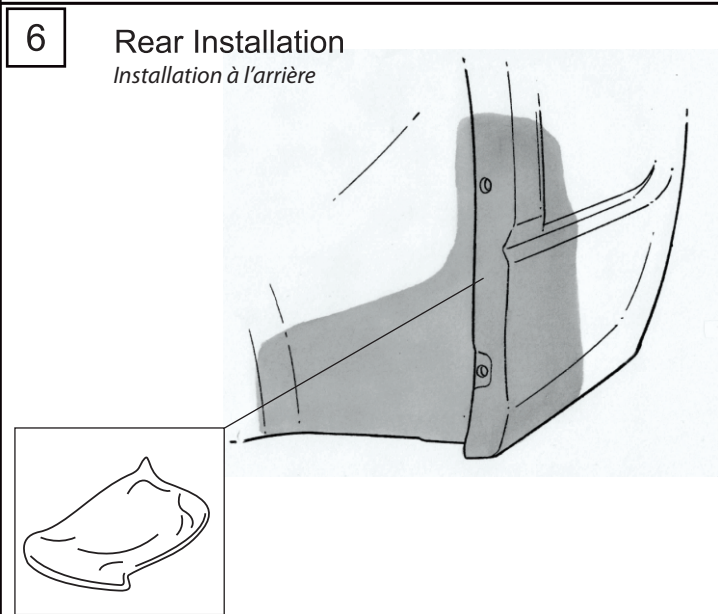
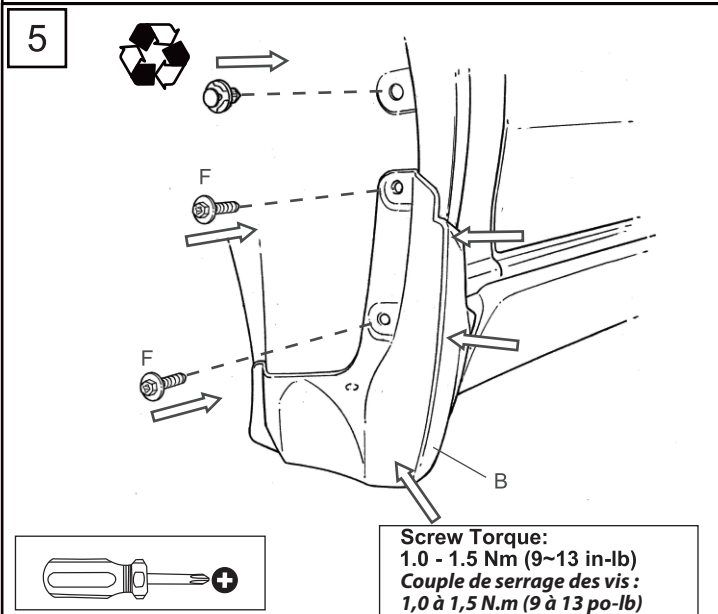
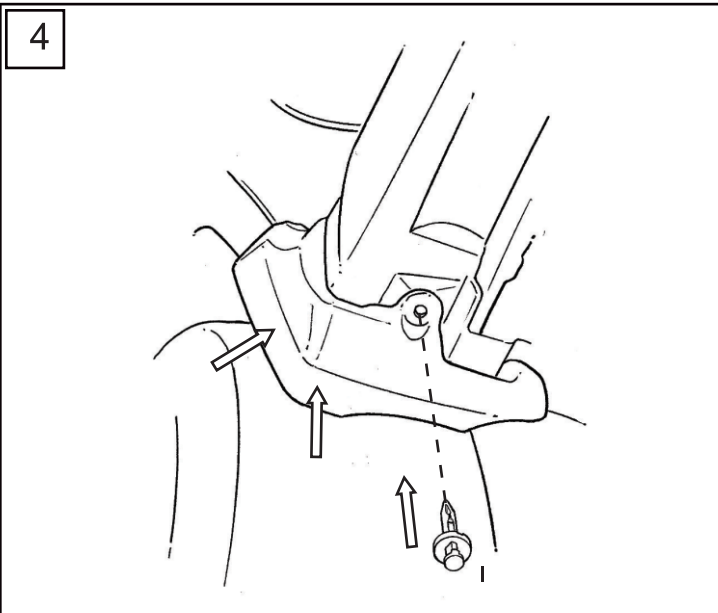
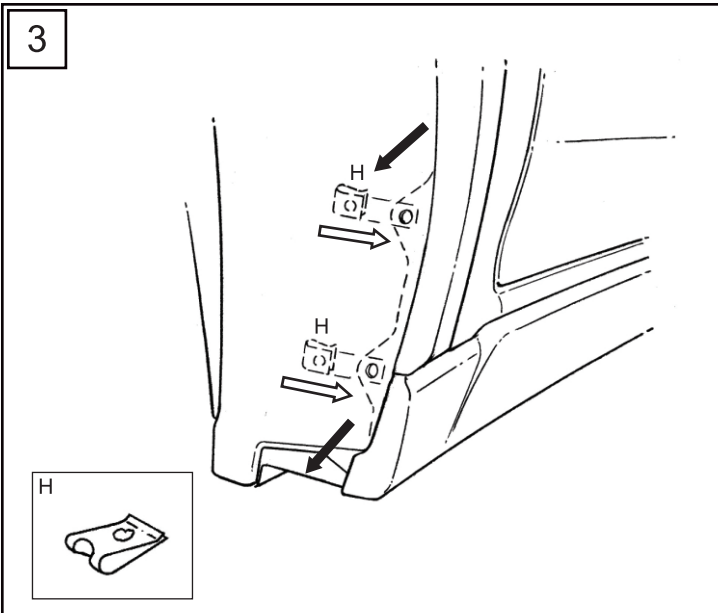

9

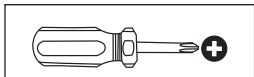
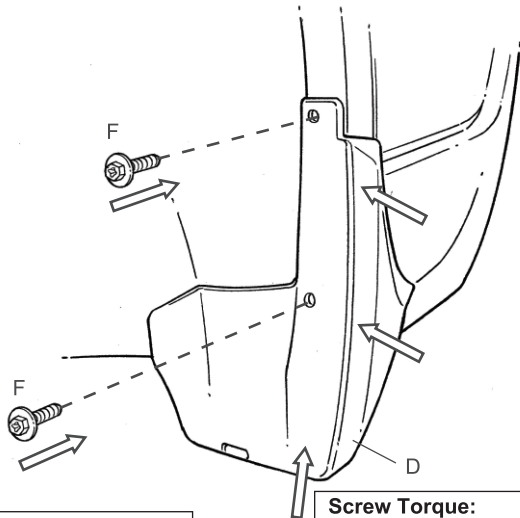

Screw Torque:
 1.0 - 1.5 Nm (9~13 in-lb)
Couple de serrage des vis :
 1,0 à 1,5 N.m (9 à 13 po-lb)

10

- Repeat steps for the other side of the vehicle
- Reprendre les mêmes étapes de l'autre côté du véhicule.